

STONEBRIDGE

Independent Estate Agents

33, Elm Way,
Shepton Mallet, BA4 5JX



Tucked away in a cul-de-sac with views of neighbouring countryside.

Asking Price: £215,000



www.stonebridgesouthwest.co.uk

Tel: 01749 330400 Fax: 01749 334370
33 High Street Shepton Mallet BA4 5AQ

Details

- * Detached
- * 2 Receptions
- * Garage and Parking
- * 4 Bedrooms
- * Front & Rear Gardens
- * Views

A detached family home tucked away on a modern development. The property comprises 4 bedrooms, bathroom, living room, dining room, kitchen and WC. There are gardens to the front and rear with the added benefit of views to the rear.

Outside

To the front of the property there is a drive providing parking and access to the garage and a garden which is mainly laid to lawn with borders of shrubs. To the rear there is a raised decked area which can be accessed via the kitchen or through French doors in the dining room. From the decking there are stairs leading to the remainder of the garden.

Tenure/Services/Local Authority

Freehold/All main services are connected/Mendip District Council

Shepton Mallet

This historic market town is conveniently located in the heart of the Mendip Hills. Approximate commuting distances to: Bath 21.5 miles, Bristol 21.1 miles, Yeovil 18.6 miles. Located approximately 6 miles from the Cathedral City of Wells, 13 miles from the tourist attraction of Cheddar Gorge and 9 miles from Glastonbury.

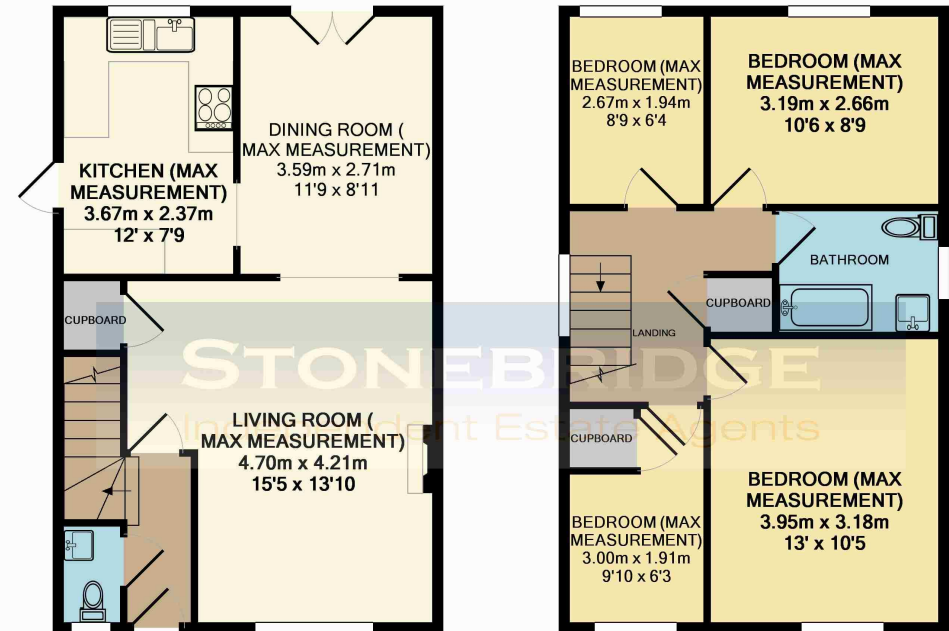

GROUND FLOOR
APPROX. FLOOR
AREA 42.3 SQ.M.
(455 SQ.FT.)

1ST FLOOR
APPROX. FLOOR
AREA 42.3 SQ.M.
(455 SQ.FT.)

TOTAL APPROX. FLOOR AREA 84.6 SQ.M. (910 SQ.FT.)
Measurements are approximate. Not to scale. Illustrative purposes only
Made with Metropix ©2008

These particulars are set out as a general outline only and do not constitute part of an offer or a contract. All descriptions, dimensions, reference to condition and necessary permissions for use and occupation, warranties and other details are given without responsibility and any intending purchasers should not rely on them as statements or representations of fact but must satisfy themselves by inspection or otherwise as to the correctness of them.